

NB. This drawing to be read in conjunction with Indigo Surveys' 'Habitat & Landscape Management Plan' (Ref. 14174/E1)

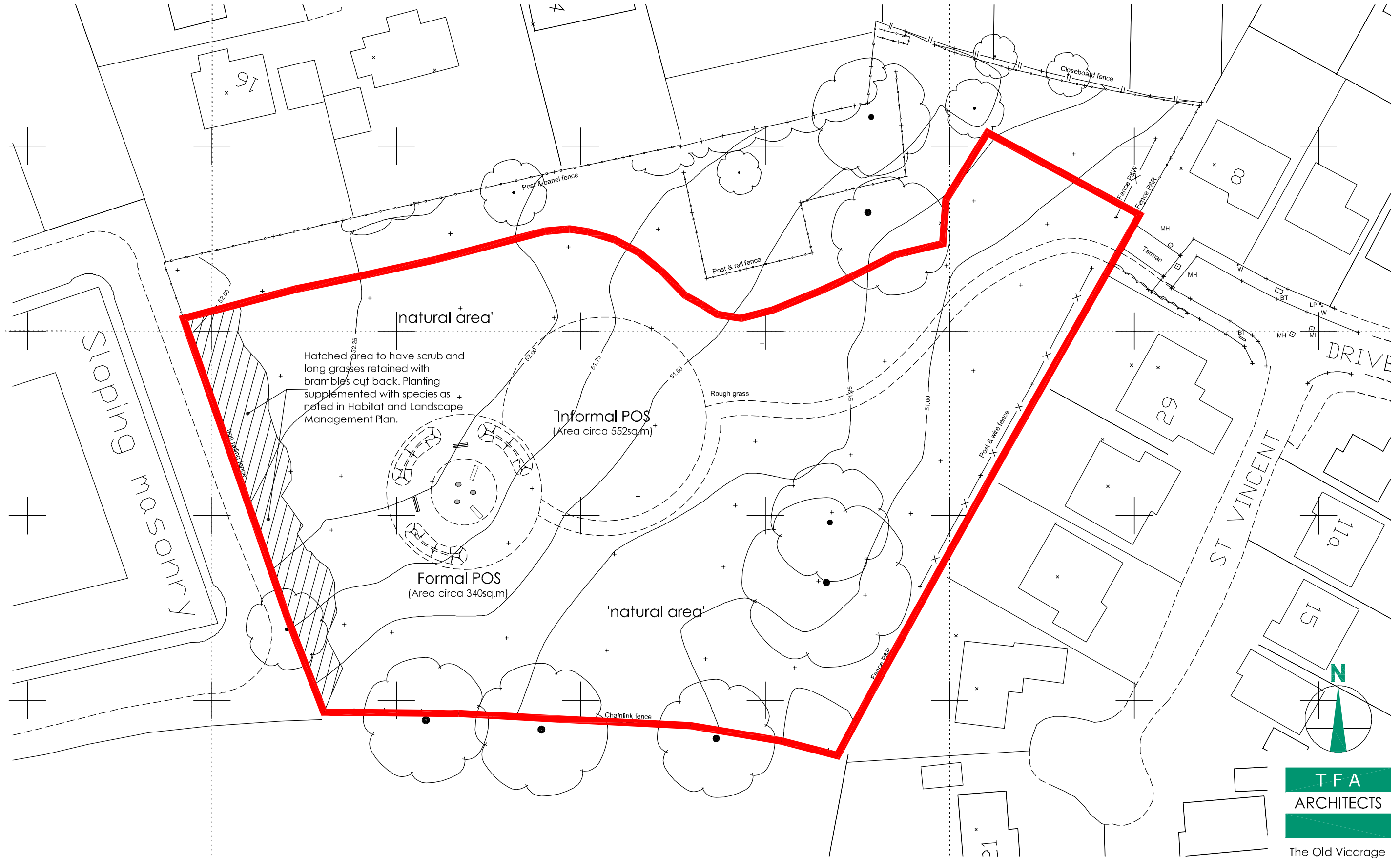

Rev. A 'natural area'+scrub notation added

19.01.15

MORNANT AVENUE / ST. VINCENT'S DRIVE, HARTFORD

POS DETAIL 1
ARCHWAY HOMES

1:500 @ A3
05.12.14

TFA
ARCHITECTS

The Old Vicarage
Stone Heyes Lane
Barnton Northwich
Cheshire CW8 4QS
T: 01606 892296
F: 01606 892325
info@tfa-architects.com

AR4004.
POS1.rev.A